

ZÜRICH

MAGNIFICENT VIEWS,
LOCAL CUISINE AND
MODERN SWISS DESIGN
MAKE THIS THE IDEAL HOME
FOR BUSINESS AND LEISURE

Swissôtel Zürich

Schulstrasse 44, 8050 Zürich, Switzerland
Tel +41 44 317 3111 Fax +41 44 317 3311
zurich@swissotel.com www.swissotel.com/zurich

swissôtel ZÜRICH

LOCATION

LOCALLY ROOTED. GLOBALLY CONNECTED

Swissôtel Zürich is the ideal relaxing alternative to the hustle and bustle of airport and city centre hotels for both business and leisure. Our central location means that you are within easy reach of Zürich's busy financial centre, the main international airport and train station - not to mention renowned cultural sites, shopping, vibrant cafés and nightlife. Whether you are holding a conference on the 31st floor, enjoying a spa treatment on the 32nd floor, or simply relaxing in one of our 347 contemporary rooms and suites, take a moment to enjoy the inspiring views across Zürich's rooftops and the Swiss Alps.



GUEST ROOMS

WELCOME HOME

At Swissôtel Zürich you experience the exceptional feeling of coming home. Finished to the highest standard, our 347 beautiful rooms and suites are complete with the latest technologies for work or relaxation. We believe that there is nothing better than a good night's sleep – so choose from our à la carte pillow menu and enjoy a comfortable bed with Swissôtel's signature linen and a superb mattress. You can also relax in one of our 16 Suites located in the corner of each floor with fantastic views over Zurich north.

RESTAURANTS & BARS

EXCLUSIVE FOOD CONCEPT BY LE MUH

Le muh restaurant

From the open kitchen you will see the Le muh team meticulously prepare delicious and creative interpretations of Swiss cuisine, skillfully produced with products from the region. Each Sunday you are invited to sample the tempting array of dishes on offer at the Sunday brunch.

Le muh bar

With over 80 cocktails to choose from, not to mention our special gin menu, there is plenty to whet your appetite. Sit back, relax and enjoy the sunshine terrace by day and the sounds of our live DJ as they play into the night.



SPA AND WELLNESS

UNWIND OVER ZÜRICH

After a busy day there is no better way to relax than in the Spa & Sport. Admire the view from the 32nd floor as you work out on our fitness training equipment or immerse yourself in the infinity pool. Truly unwind in our sauna, steam bath, or book a massage or beauty treatment with one of our specialists.

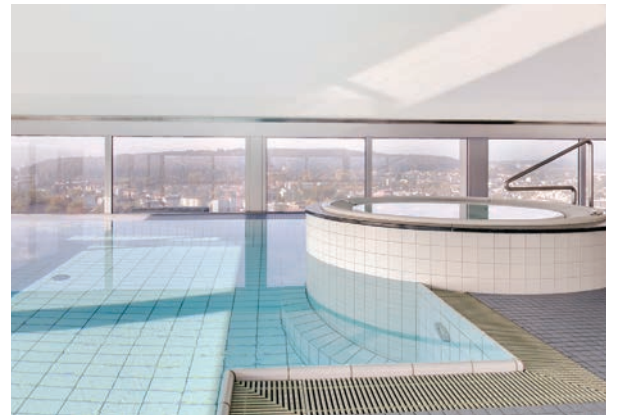

CONFERENCES, MEETINGS & EVENTS

CREATE A LASTING IMPRESSION

Our 17 state-of-the-art meeting- and event rooms are among the largest in Zürich, with over 1,025 square metres of stylish versatile space for up to 800 people. The showstopper has to be the City Ballroom, with a ceiling height of almost six metres. The fully equipped meeting rooms located on the 31st floor afford breathtaking views over Zürich. The hotel also provides a dedicated meeting specialist to ensure your event is a success. Whether for an international conference or an exclusive and more intimate meeting, our facilities, service and team are guaranteed to leave a lasting impression.

VITALITY SUITE

THE HOTEL ROOM OF THE FUTURE

Our new Vitality Suite, created in partnership with Wallpaper* magazine, takes our live it well philosophy to the next level and paves the way for the future of well-being and hospitality.

In collaboration with partners who share our commitment to sustainability, luxury, craftsmanship and functionality in design, this serene and stylish sanctuary features bespoke wellness features that will help guests to stay active, eat well, feel rested, and be productive.



FACILITIES & SERVICES

SWISSÔTEL ZÜRICH HIGHLIGHTS



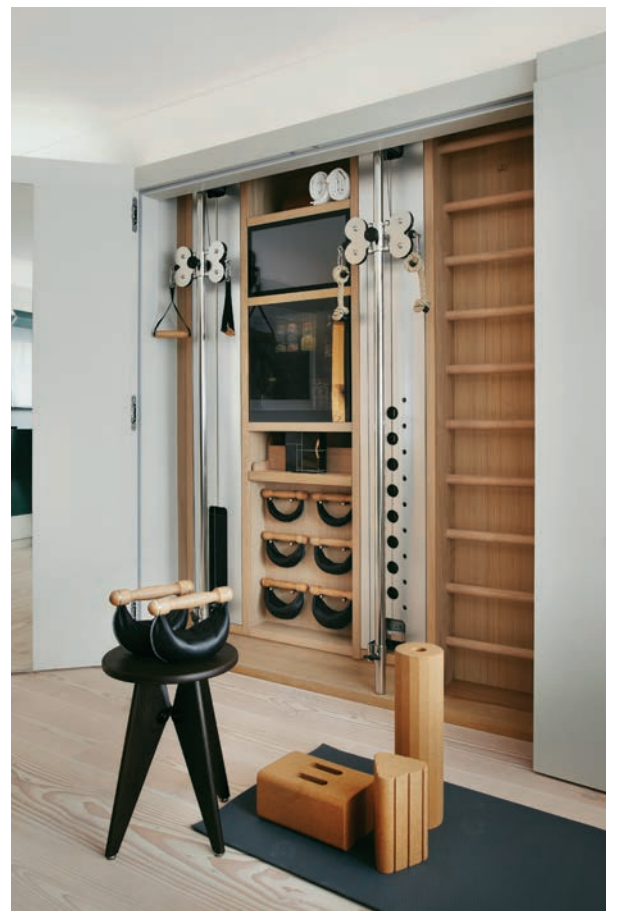





- Centrally located international hotel
- Located adjacent to Zürich Oerlikon train station
- 5 minute train ride to both the Zürich Airport and Zürich city centre
- 347 beautiful and contemporary rooms and suites
- 141 newly renovated rooms and suites
- Vitality Suite - the hotelroom of the future of well-being and hospitality
- In-house Le muh restaurant and bar
- 24-hour in room dining
- Spa & Sport centre with infinity pool and fitness area
- In-house florist and laundry service
- Wireless internet
- 24-hour concierge service
- Car park with 450 parking lots and 3 e-parking lots
- Professional conference, meeting and event facilities
- Car elevator to the first floor
- Catering available for external functions and events

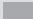

CAPACITY CHART

MEETING ROOMS	AREA FT ²	AREA M ²	L	W	H	THEATRE	CLASS ROOM	BANQUET	BOARD ROOM	U-SHAPE	RECEPTION/ COCKTAIL
CONVENTION FLOOR											
City Ballroom (Zürich & Basel & Bern)	6,835	635	30	22	3.2-5.8	700	420	504	-	-	-
Zürich	2,691	250	22	12	3.2-5.8	260	160	176	-	56	250
Basel	2,368	220	22	10	3.2-5.8	240	144	144	-	54	200
Bern	1,776	165	22	8	3.2	170	108	96	-	45	150
Lakeside Ballroom	3,875	360	21	19	3.2	350	250	264	-	-	300
Vevey	344	32	5	6	3.2	24	15	18	12	15	20
Lausanne	431	40	7	6	3.2	24	18	18	15	15	25
Montreux	829	77	9	8	3.2	50	42	45	24	27	50
Genf	1,033	96	10	9	3.2	60	50	54	27	32	80
Biel	700	65	9	7	3.2	50	39	45	24	24	60
Montreux & Genf	1,830	170	19	9	3.2	140	102	96	-	45	160
PANORAMA FLOOR											
Arosa	506	47	6	8	2.7	30	18	32	14	16	35
Davos	366	34	8	4	2.7	20	16	16	14	14	20
St. Moritz	398	37	11	3	2.7	30	20	24	22		30
Saas Fee	398	37	8	5	2.7	24	12	16	14	14	20
Zermatt	334	31	7	5	2.7	20	12	16	14	14	20
Grindelwald	624	58	Lounge	Lounge	2.7	-	-	-	-	-	-
Arosa & Davos	872	81	11	8	2.7	60	42	45	30	30	60
Saas Fee & Zermatt	732	68	14	5	2.7	55	42	36	26	28	60

LEGEND

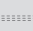
-  Meeting Room or Ballroom
-  Restrooms
-  Escalator
-  Elevator
-  Food & Beverage Outlet
-  Emergency Exit
-  Stairway
-  Window
-  Moveable Partition

CONVENTION FLOOR

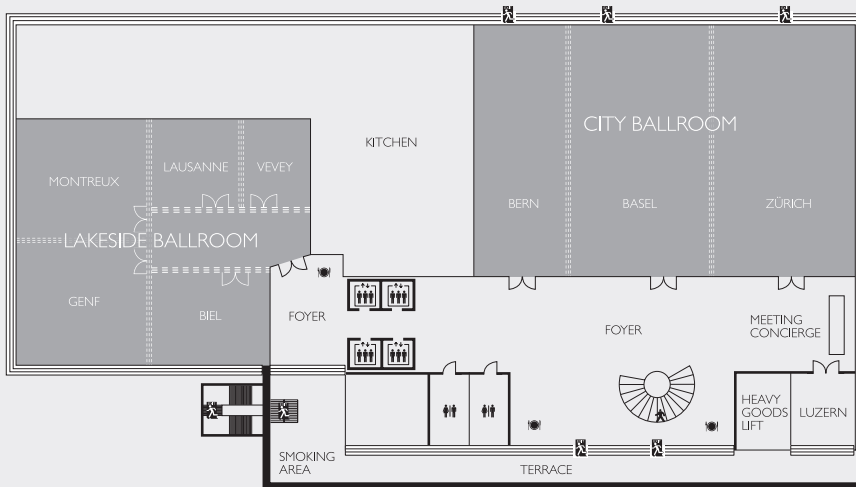

PANORAMA FLOOR

