

LOTTE

HOTELS & RESORTS

MOSCOW



EST. 1928

THE LEADING HOTELS
OF THE WORLD*

LOTTE HOTEL MOSCOW

LOTTE HOTEL



[01 LOCATION](#)

[02 MAIN FEATURES OF LOTTE HOTEL MOSCOW](#)

[03 GUEST ROOMS](#)

[05 MENU RESTAURANT](#)

[06 MEGU RESTAURANT](#)

[07 THE TERRACE](#)

[08 CONFERENCE AND BANQUET FACILITIES](#)

[09 2ND FLOOR PLAN](#)

[10 BANQUET HALLS: CRYSTAL](#)

[11 BANQUET HALLS: CHARLOTTE & EMERALD](#)

[12 BANQUET HALLS: SAPPHIRE](#)

[13 BANQUET HALLS: TOPAZ](#)

[14 BANQUET HALLS: RUBY](#)

[15 UNIQUE CONFERENCE FACILITIES](#)

[16 OUTSIDE CATERING](#)

[17 AWARDS](#)

[18 CONTACTS](#)

← LOCATION

LOTTE Hotel Moscow is strategically located in the center of Moscow, in immediate proximity to the Kremlin and the Red Square. Offering easy access to business, shopping and entertainment facilities, LOTTE Hotel Moscow is only a few kilometers from main railway stations and a comfortable drive from the Moscow International Airports.

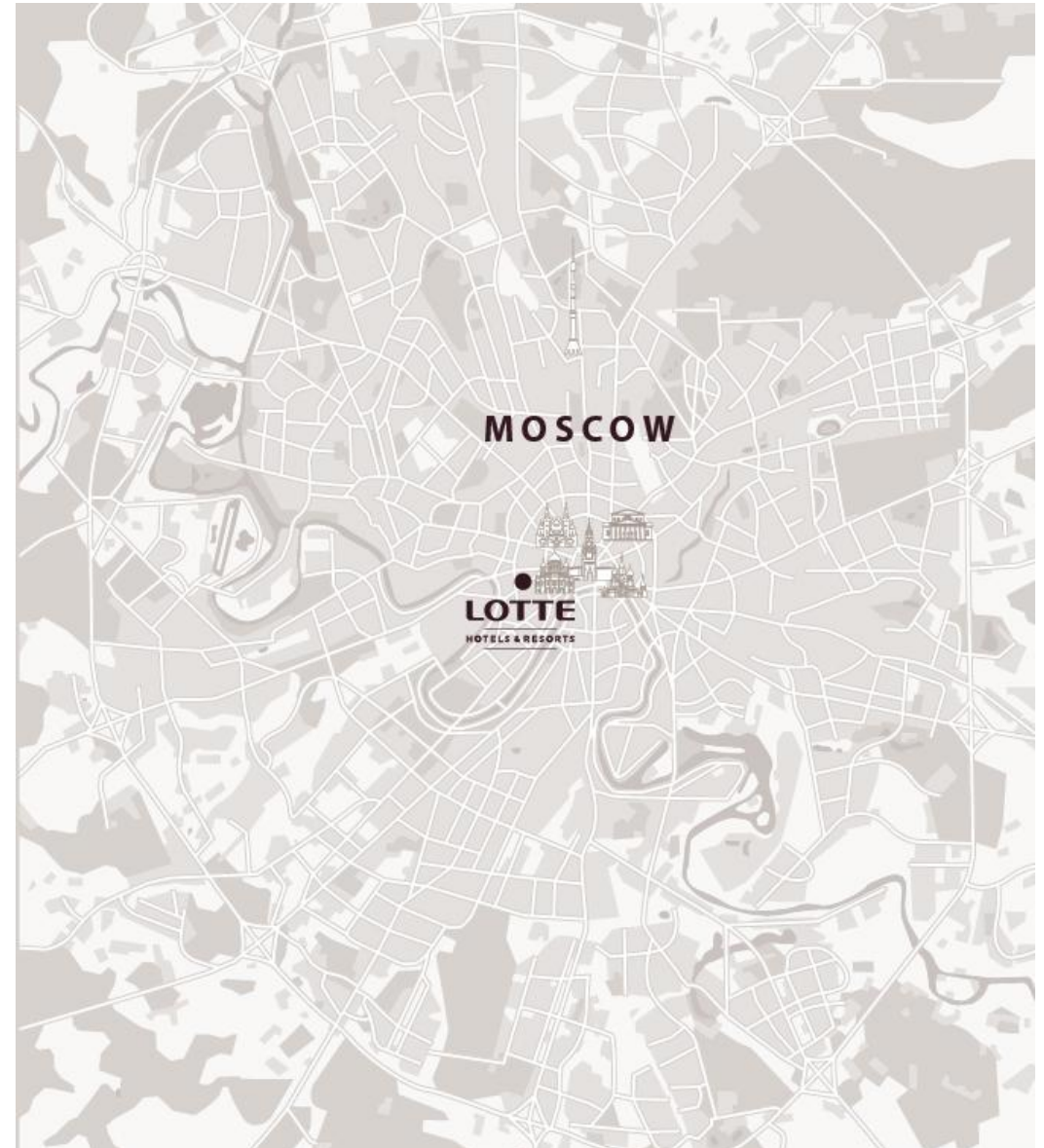

← MAIN FEATURES OF LOTTE HOTEL MOSCOW



- The architectural concept and decor of the hotel were created by world-renowned design companies: Hirsch Bedner Associates and Wilson & Associates.
- The most large-scale investment project in the Russian market. The total financial investment in the construction works compose over USD 350 million.
- The biggest and the most expensive Royal Suite in Russia.
- Innovative Club Lounge with a library, state-of-the-art office appliances, meeting rooms and five food presentations during the day.
- 2 superb restaurants: European MENU and Japanese MEGU
- World-famous Balinese Mandara Spa

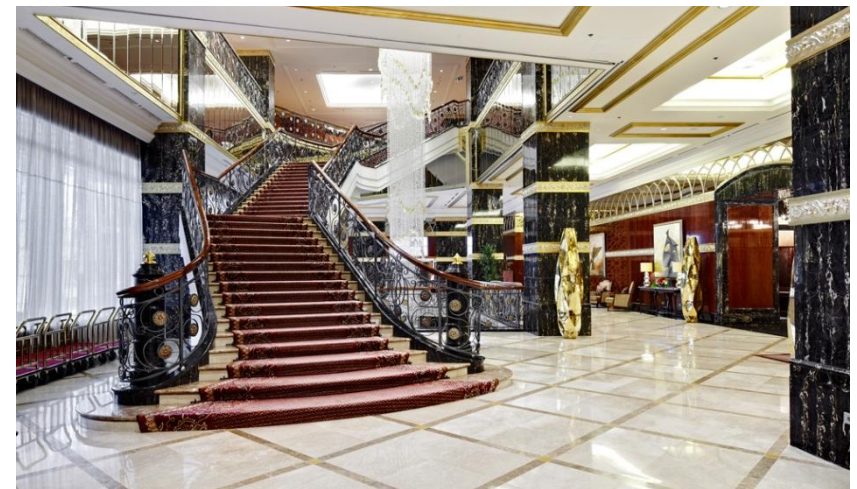

← GUEST ROOMS: SUPERIOR ROOM

Hotel Rooms & Suites:

Each guest room offers lavish comfort in a stylish setting. Elegant and exquisite interiors are combined with breathtaking views over Moscow downtown.

Superior Room guarantee the guests comfort in an elegant atmosphere. Every room has a comfortable king-size bed, a living area, top-of-the-range technology and a luxurious marble bathroom.

Room categories:

- Superior Room (40~48 sq m / 430~516 sq feet)
152 rooms
- Deluxe Room (50~56 sq m / 538~600 sq feet)
66 rooms
- Luxury Room (56~68 sq m / 600~730 sq feet)
21 rooms
- Atrium Suite (55~67 sq m / 590~720 sq feet)
23 suites
- Junior Suite (85~97 sq m / 914~1044 sq feet)
23 suites
- Executive suite (81~97 sq m / 870~1044 sq feet)
10 suites
- Charlotte Suite (97~136 sq m / 1044~1460 sq feet)
3 suites
- Presidential Suite (200 sq m / 2150 sq feet)
1 suite
- Royal Suite (490 sq m / 5270 sq feet)
1 suite



SUPERIOR ROOM

SPECIAL FEATURES

- Complimentary Internet access
- Digital control smart panel
- Samsung Galaxy Tab (guest service directory)
- Music docking station
- Bathroom amenity (Molton Brown)
- Luxurious bathrobe, slippers
- Japanese bidet toilet TOTO
- Complimentary access to the fitness center & swimming pool

- Complimentary underground parking

BED TYPE King / Twin

VIEW City / Courtyard

CAPACITY 2 persons

SIZE 40~48 sq m /
430~516 sq feet

← MENU RESTAURANT

The MENU restaurant offers progressive European cuisine that combines the best classical Mediterranean dishes with a modern twist by our experienced chef. Signature dishes artistically created with meticulous attention to every detail create an unforgettable feast for all the senses.

- 3 Private Rooms - Capucine, Violette, Pivoine

Open:

Mon-Fri 12:00-22:30
Sat, Sun 18:00-22:30

Breakfast:

Mon-Fri 06:30-10:30
Sat, Sun 06:30-12:00



← MEGU RESTAURANT



The enchanting taste of MEGU, a trendy Japanese restaurant from New York, is exclusively presented in Moscow. MEGU delivers sophisticated, organic dining experience – a genuine triumph of the very best in service, ingredients and cutting-edge aesthetics.

- Original design concept: bolts of brightly colored antique kimono fabrics cover The Kimono Lounge. Suspended in the main dining room is a traditional Japanese bronze temple bell called a “bonsho” bell. It is an exact replica of the largest bell in Japan which is hung in the Todaiji temple in Nara.
- A carefully selected wine and sake list.
- A sushi-bar with an open kitchen.
- 4 private rooms - Sakura, Kiku, Hanabi, Ran

Open:

Mon-Fri 12:00-22:30

Sat, Sun 14:00-22:30

- BEST HOTEL RESTAURANT by Condé Nast Traveller Russia
- SIX STAR DIAMOND AWARD by the American Academy of Hospitality Sciences (AAHS)
- BEST HOTEL RESTAURANT by TimeOut
- BEST NEW RESTAURANT by TimeOut

← THE TERRACE



A spacious summer Terrace as a part of the Club Lounge is also available for guests in the summertime.

The Terrace offers exquisite cuisine, refreshing cocktails and marvelous views over Moscow's downtown.

Open:

May - October



← CONFERENCE AND BANQUET FACILITIES



- 6 banquet halls to accommodate any kind of the event: small social gatherings, business seminars and international conventions.
- Unique “Crystal” Ballroom with the total square of 600 sq m is situated on the 2nd floor in a private guest area. The room easily can be divided into three soundproof function spaces: “Crystal I” and “Crystal III” 140 sq m each and “Crystal II” with the square of 290 sq m. Each room can be used for large receptions, dinners and wedding parties as well as for exhibitions and workshops. Its modern technical equipment allows to organize conferences up to 650 persons.
- Very spacious 1000 sq m and light foyer at the front of the “Crystal” ballroom can be used for registration of participants, coffee-breaks, lunches, dinners and cocktail reception.
- The 4 tonnage freight lift allows to hold car presentation events at the Ballroom or pre-function area.
- Free Wi-Fi high-speed internet access.
- Business center services.
- Elegant settings and flawless service along with convenient transportation and parking facilities will make any function a success.

← 2ND FLOOR PLAN

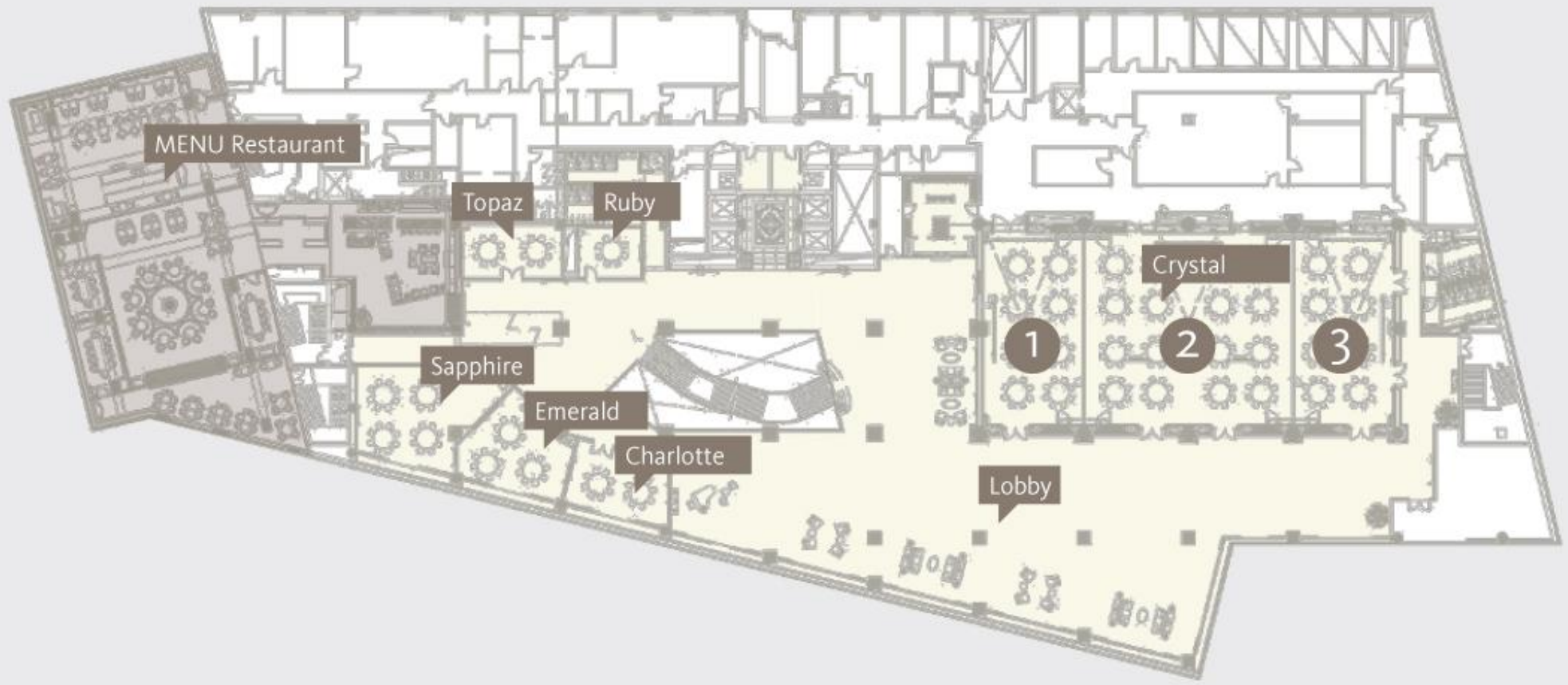

← BANQUET HALLS: CRYSTAL

Name	Capacity						Area (sq m)	High ceiling	Floor
	Banquet 10 round	Reception	Classroom	Board room	U-Shape	Theater			
Crystal	320	500	300	90	110	580	580	4.79	2
Crystal 1	80	120	60	30	30	140	140	4.79	
Crystal 2	160	260	150	40	50	300	290	4.79	
Crystal 3	80	120	60	30	30	140	140	4.79	



← BANQUET HALLS: CHARLOTTE & EMERALD

Name	Capacity						Area (sq m)	High ceiling	Floor
	Banquet 10 round	Reception	Classroom	Board room	U-Shape	Theater			
Charlotte & Emerald	70	80	70	45	40	110	110	2.99	2



← BANQUET HALLS: SAPPHIRE

Name	Capacity						Area (sq m)	High ceiling	Floor
	Banquet 10 round	Reception	Classroom	Board room	U-Shape	Theater			
Sapphire	50	70	60	20	25	90	70	2.99	2



← BANQUET HALLS: TOPAZ

Name	Capacity						Area (sq m)	High ceiling	Floor
	Banquet 10 round	Reception	Classroom	Board room	U-Shape	Theater			
Topaz	20	25	15	10	14	30	30	2.99	2



← BANQUET HALLS: RUBY

Name	Capacity						Area (sq m)	High ceiling	Floor
	Banquet 10 round	Reception	Classroom	Board room	U-Shape	Theater			
Ruby	10	15	10	8	6	20	21	2.99	2



← UNIQUE CONFERENCE FACILITIES



← OUTSIDE CATERING

Our exclusive Outside Catering service brings a spark to any occasion either you are planning a business breakfast, fabulous formal dinner, unforgettable wedding or a garden party. Impress your guests with contemporary, innovative and fresh flavours created for you by LOTTE Hotel Moscow.



- BEST BREAKFAST IN A HOTEL IN EUROPE by Prix Villégiature Awards
- BEST CITY HOTEL IN RUSSIA by Condé Nast Traveller magazine
- BEST HOTEL IN EUROPE by Prix Villégiature Awards
- №5 HOTEL AMONG 'LUXURY HOTELS IN EUROPE' by TripAdvisor Travellers' Choice Awards
- №1 HOTEL IN RUSSIA by TripAdvisor Travellers' Choice Awards
- LUXURY HOTEL OF THE YEAR by Russian Hospitality Awards
- BEST LUXURY BUSINESS HOTEL by World Luxury Hotel Awards
- BEST HOTEL IN RUSSIA by International Hotel Awards
- BEST CONVENTION HOTEL IN RUSSIA by International Hotel Awards
- TRIPADVISOR CERTIFICATE OF EXCELLENCE WINNER
- BEST LUXURY HOTEL by Russian Hotel Awards
- BEST HOTEL IN HOSPITALITY ART by "My Planet " national TV channel
- BEST HOTEL IN RUSSIA by European Hotel Awards
- BEST HOTEL FOR WEDDINGS by Element magazine
- BEST CITY HOTEL IN RUSSIA by "My Planet" national TV channel
- BEST LUXURY HOTEL IN RUSSIA by World Luxury Hotel Awards





CONTACTS

Denis Logachev

Director of Sales and Marketing

E dlogachev@lottehotel.ru

Julia Ryzhkova

Director of Sales

E jryzhkova@lottehotel.ru

Salome Lomsadze

Catering Sales Director

E slomsadze@lottehotel.ru

