

## ROOMS & SUITES

The hotel has 232 rooms, including 26 Suites and 14 rooms for disabled guests. The rooms are furnished in three locally designed styles: Wave, Raft, and Elle, each with its own identity. All guest rooms are equipped with flat screen televisions, satellite channels, free high-speed wireless Internet access, in-room safe, hair dryer, pay TV and open bathroom.

The 125 m<sup>2</sup> Presidential Suite sleeps up to four guests and is furnished with a 2 metre Jacuzzi, a separate guest bathroom and a terrace with its own grass lawn and view over the ancient Roman aqueduct.

The Business Suite can be easily converted into a meeting room and features, additionally, a large working desk, mega screen plasma TV and separated bathroom.

The Fitness Suite is furnished with exercise equipment and has a lovely terrace.

The Sweet Junior Suite is an ideal space to relax, thanks to a large living area, chaise longue and a Jacuzzi.

## FITNESS & RELAXATION

The "es.ere" spa and fitness centre, located on the top floor, offers heaven of tranquillity of an urban spa with exclusive treatments, a roof top 20-metre swimming pool and smaller children's pool, and a sun deck for guests' relaxation.

STANDARD ROOM



SUPERIOR ROOM



JUNIOR SUITE

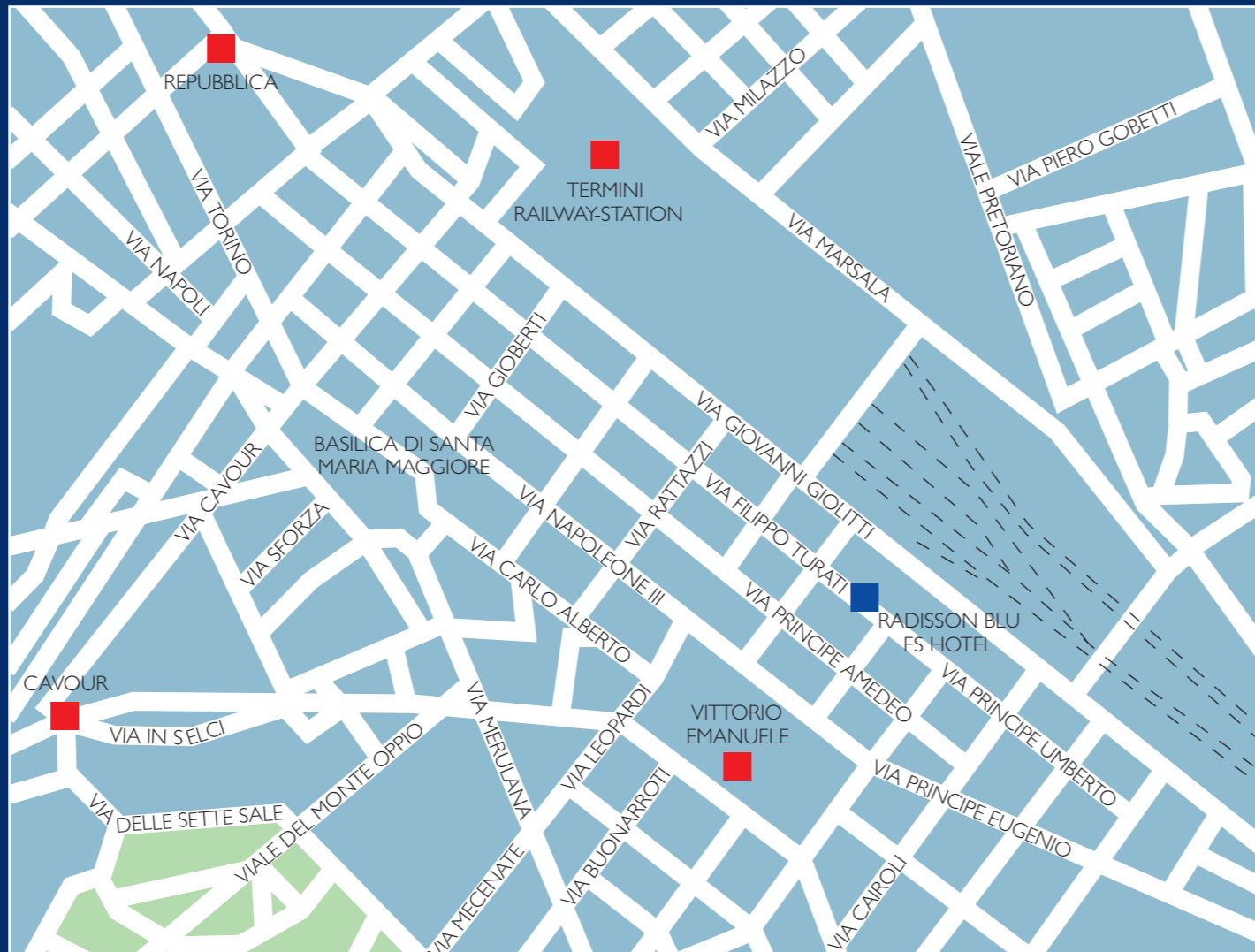

## BY CAR

From the highway A1 (coming South from Florence or North from Naples), follow indications to the GRANDE RACCORDO ANULARE (GRA). From the GRA (ring road) towards "EUR/Magliana" for 6 km, exit at "centro/Via Laurentina", then take the "autostrada Roma-Fiumicino", or A91, for 3 km towards "centro". Exit Via Cristoforo Colombo. Follow for 4 km. Make a left at Terme di Caracalla, then make a right at Piazzale Numa Pompilio, then make a quick left on Via Druso.

Make a right on Largo dell'Amba Aradam, and continue along Via della Ferratella in Laterano for 350 m. Make a left on Via dei Laterani, then make a right on Via dell'Amba Aradam, then continue along Piazza di San Giovanni in Laterano. Make a left on Via Merulana and a right on Via Machiavelli, make a right on Piazza Vittorio Emanuele and then make a right on Via Mamiani. Take the first left on Via Principe Amedeo, the next right on Via Alfredo Cappellini, and the first right on Via Filippo Turati.

## BY TRAIN

International Train Service. Termini Railway station, which is the central station for Rome and the base for all train transport, connects Rome with all of Italy and Europe. It is a 5 minute walk from the hotel. In addition, the Leonardo Express train, which takes you to and from Leonardo Da Vinci Fiumicino Airport, is a quick 40 minute train ride, and runs twice an hour from 5:30 a.m. until 11:30 p.m.

## BY AIR

Leonardo Da Vinci Fiumicino Airport is located 32 km west of the hotel. Upon arrival you may take a taxi from the airport, which should take about 30 minutes, or you can take the Leonardo Express train - a quick 40 minute train ride from the Airport, and runs twice an hour from 5:30 a.m. until 11:30 p.m.

Radisson Blu es. Hotel, Rome  
Via Filippo Turati 171, 00185 Rome, Italy  
Ph: +39 06 444 841, Fax: +39 06 444 843 97  
info.rome@radissonblu.com  
radissonblu.com/eshotel-rome

ENGLISH 03/06

## MEETING PLANNER

Radisson Blu es. Hotel, Rome, Italy

# WELCOME TO RADISSON BLU



## WELCOME

The Radisson BLU es. Hotel, Rome is located in the heart of Rome on the Esquiline Hill, one of the seven Roman hills, adjacent to Roma Termini Central Railway Station and within easy access to the express train connecting to Fiumicino Airport, which at 32 km distance, is only a 40 minute train ride away.

Rome is a vast 3,000-year-old open-air museum where one can find ancient monuments, art, architectural treasures and archeological wonders. All within easy access from the hotel. In addition, vibrant Rome also offers design, green parks, cultural festivals, street cafes and shopping to indulge.

HOTEL LOBBY



DETAIL



HOTEL LOBBY



Radisson BLU  
es. HOTEL, ROME



## RESTAURANTS & BARS

On the 7th floor, in a spectacular setting overlooking the city, the hotel offers 2 restaurants. The 170-seater "Zest" serving breakfast and light snacks is also ideal for quick buffet business lunches.

Next to it, overlooking the swimming-pools, the 100-seater "Sette" Restaurant is the modern, hip Italian, gourmet restaurant. Thanks to the mild roman weather, the pool deck and the "Sette" are a fantastic setting for candle light dinners up to 160 guests. For larger in-door dinners the "Zest" and the "Sette" can be joined and become one unique 270-seater restaurant.



## MEETINGS & EVENTS

Located on the lobby level, the 500 m<sup>2</sup> "XL" Conference Centre is available for seminars, videoconferences, business meetings and special events. It can hold up to 500 delegates or be divided into three smaller conference rooms: "S", "M" and "L" to be combined according to the number of participants and set up chosen.

The Centre offers the latest audio-visual technology including touch screen panels, two giant screen projectors and four 50" plasma screens.

On the first floor, directly connected to the Conference Center, is located the es. Libris Lounge: a 300 m<sup>2</sup> stylish area, ideal for exhibition, coffee breaks and receptions.

On the 7th floor the "Conference Sette", able to accommodate up to 60 participants, offers a private terrace for out-door coffee breaks and a stunning view of the city.

Other conference facilities include 7 "Meeting Suites" (42 m<sup>2</sup>) for up to 20 delegates.

Wire-less is complimentary in all meeting rooms. All meeting rooms and meeting suites offer natural day light.

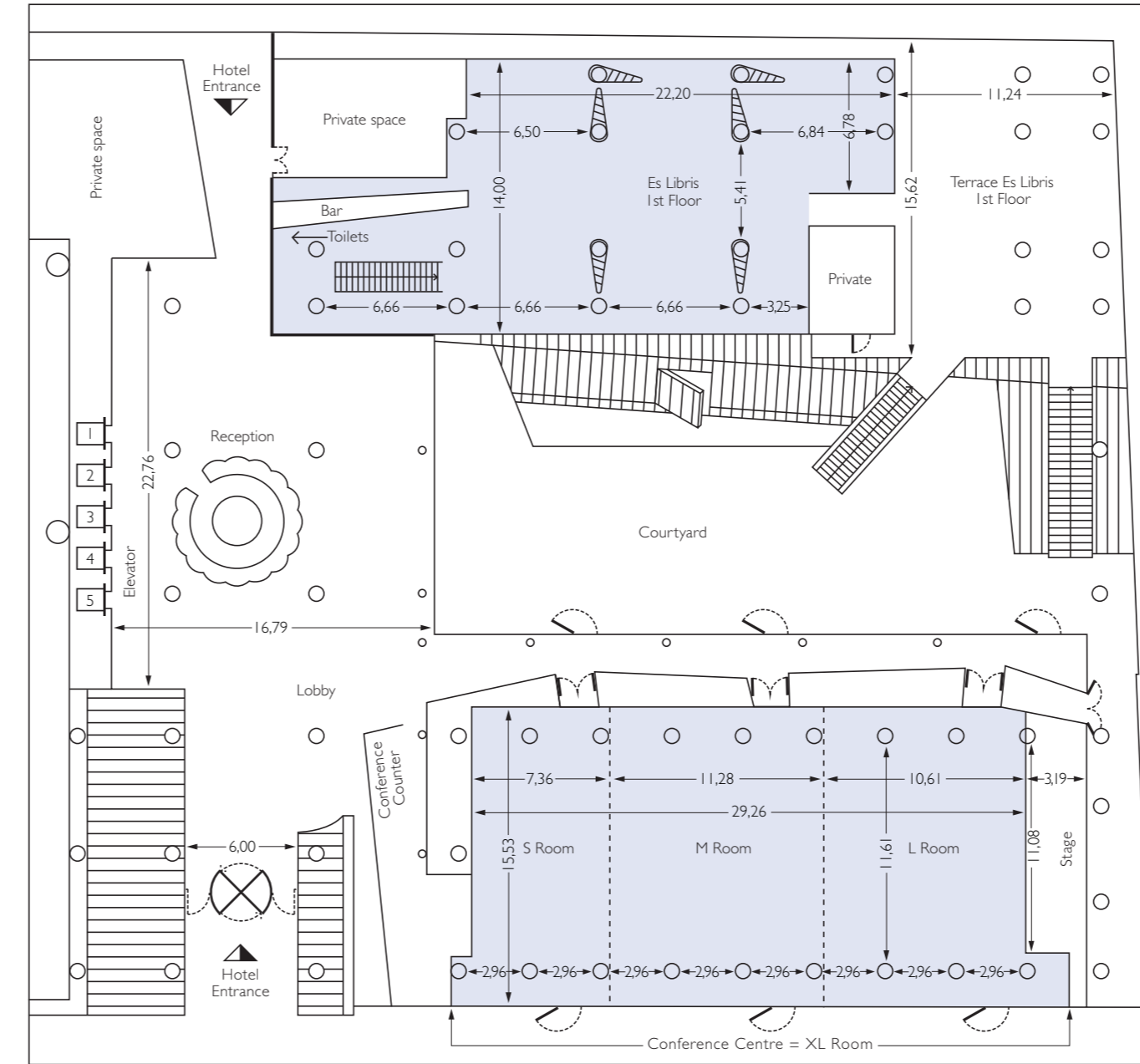

LOBBY LEVEL AND FIRST FLOOR

MEETING ROOM HEIGHTS

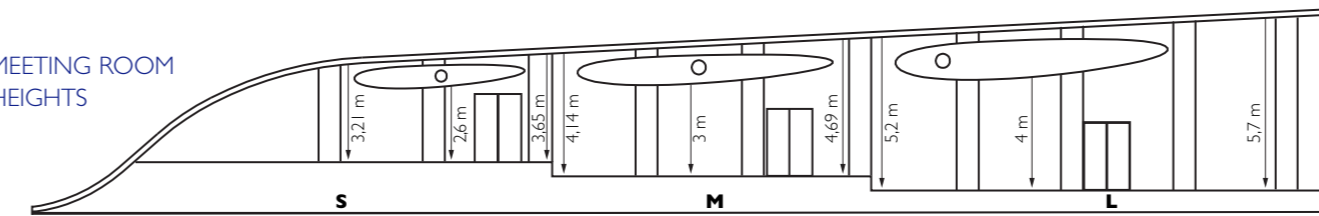

MEETING CAPACITIES

	Boardroom	Classroom	U-Shape	Theatre	Charet	Row to ceiling height	Square Poles	Door Height	Door Width	Wireless	Daylight	Air Conditioning
S	30	42	24	64	28	2,6 m	114	2,3 m	1,76 m	Yes	Yes	Yes
M	36	78	33	160	56	3 m	175	2,3 m	1,76 m	Yes	Yes	Yes
L	36	84	33	160	56	4 m	217	2,3 m	1,76 m	Yes	Yes	Yes
XL (S+M+L)	na	234	na	500	140	-	497	2,3 m	na	Yes	Yes	Yes
Meeting Suite 1-7	14	na	na	20	na	2,66 m	42	2,1 m	0,89 m	Yes	Yes	Yes
Conference Sette	24	45	27	60	28	3 m	121	3 m	1,90 m	Yes	Yes	Yes

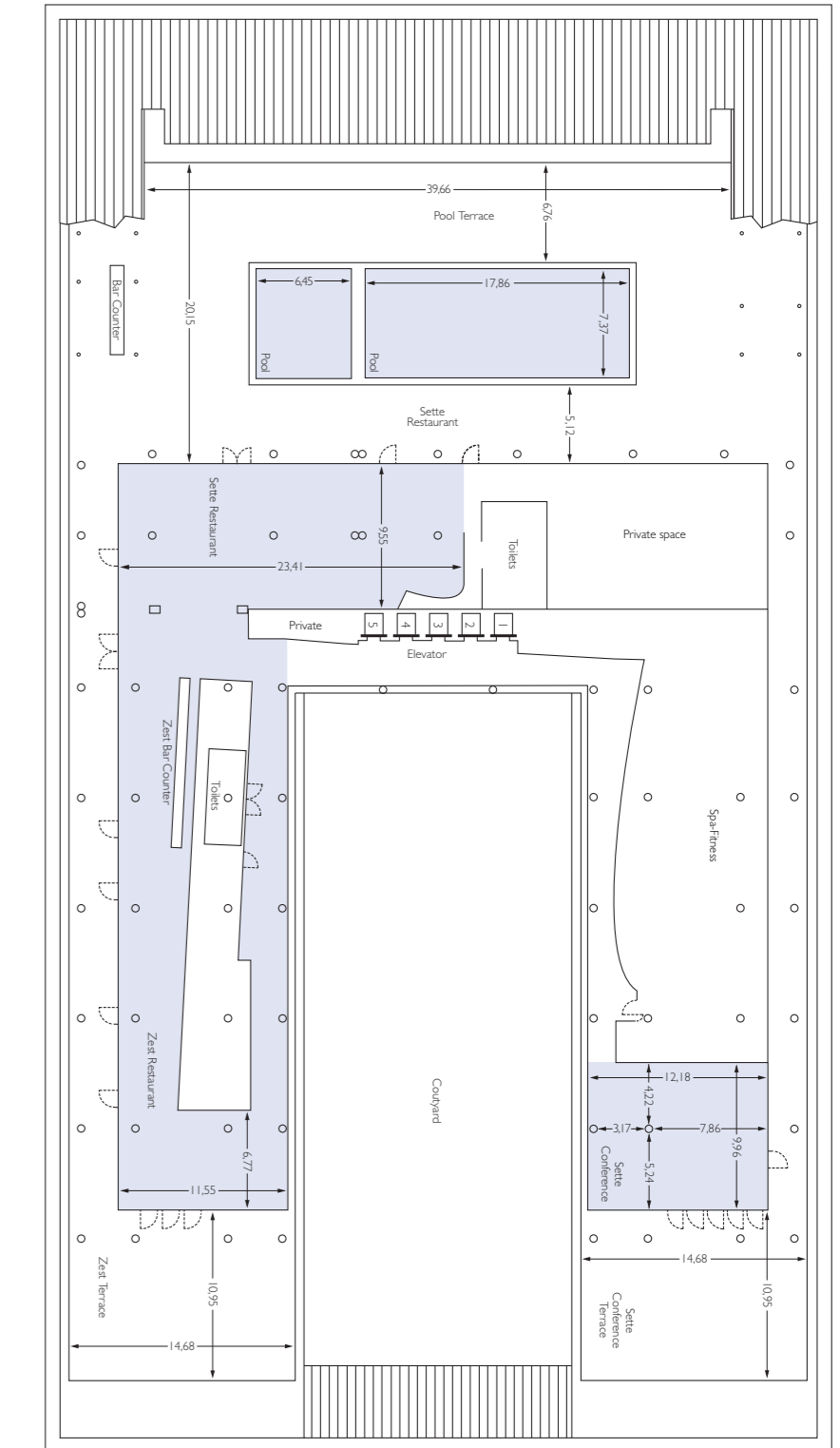

7TH FLOOR

RESTAURANTS CAPACITIES

	Place	Buffet	Cocktail
Es Libris	100	100	400
Conference Sette	50	50	100
Zest	170	170	250
Sette	100	90	180
Zest + Sette	270	260	500
Pool	160	160	300
Sette + Pool	260	250	480

