



MEETINGS & INCENTIVES AT THE EDGE OF THE MATTERHORN





HOTEL POLLUX, ZERMATT

The 4**** Hotel Pollux is situated in the heart of Zermatt, only 200 m from the railway station.

The hotel offers 2 restaurants, a bar with fireplace, a nightclub «T-Bar Let's dance», a conference and living room, a wellness area with Finnish sauna, steam bath, Jacuzzi, Spa shower and solarium. The rooms are decorated in a modern design combined with rustic elements.

All rooms are equipped with bath/toilet, hair-dryer, make-up mirror, wireless internet, telephone, LED flat screen with Smart Hub and international radio and TV channels, minibar and safe.

The different types of rooms can meet the individual needs such as for example family room with connecting door.





CONFERENCE ROOMS

Our conference room with daylight and option of darkening measures 75 m² and may be divided into two rooms. Room A has a size of 47 m² and room B 28 m². Depending on the seating arrangement our conference room provides space for up to 50 people. Comfortable chairs and spacious, adaptable working tables are during intensive meetings and conferences greatly appreciated.





CONFERENCE ROOMS & TECHNOLOGY

- Mobile and fixed screen
- 2 beamer
- 3 flip charts
- Small sound system
- Overhead projector
- Presentation case
- Pads and pens
- Wireless and ADSL - Internet
- Bulletin board
- TV / DVD-player
- A copy machine and a fax are available at the reception.

Additional technical equipment we can provide on request.



SEATING ARRANGEMENTS

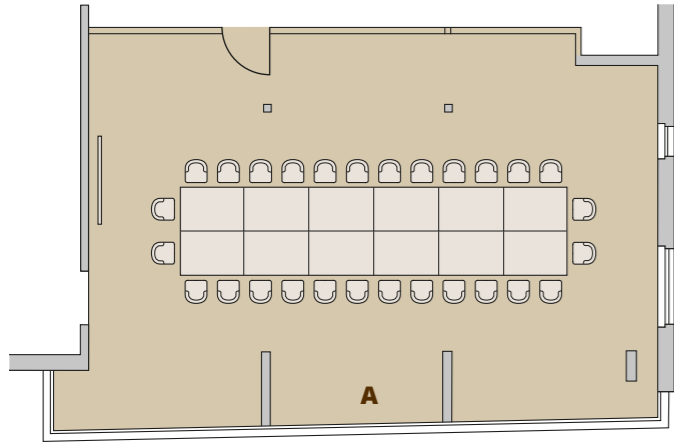

Option 1
Seating capacity A: 28

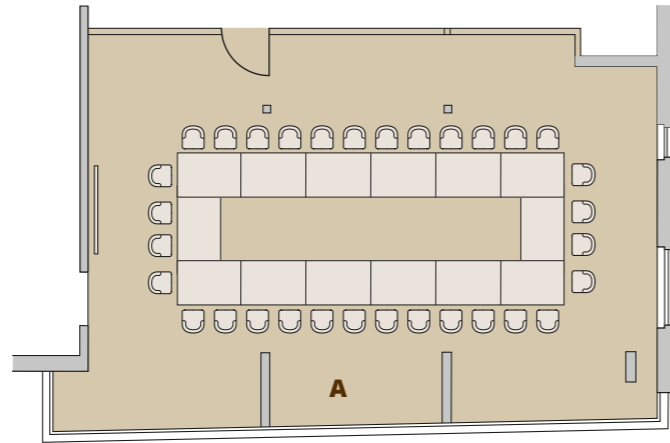

Option 2
Seating capacity A: 32

SEATING ARRANGEMENTS

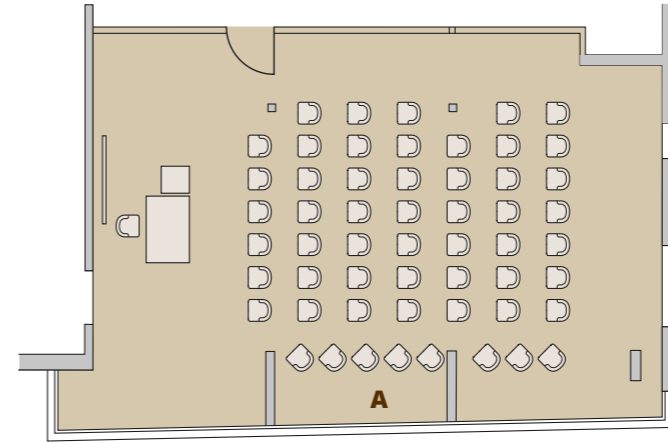

Option 3
Seating capacity A: 50

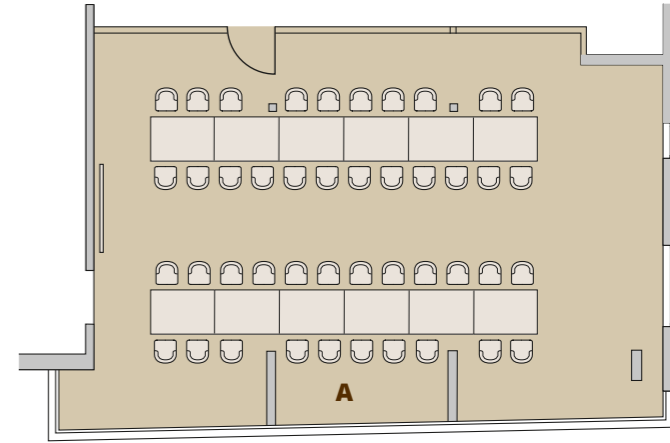

Option 4
Seating capacity A: 40

SEATING ARRANGEMENTS

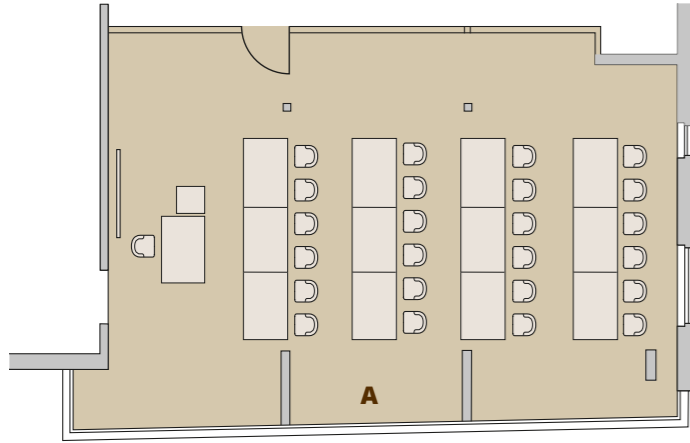

Option 5
Seating capacity A: 24

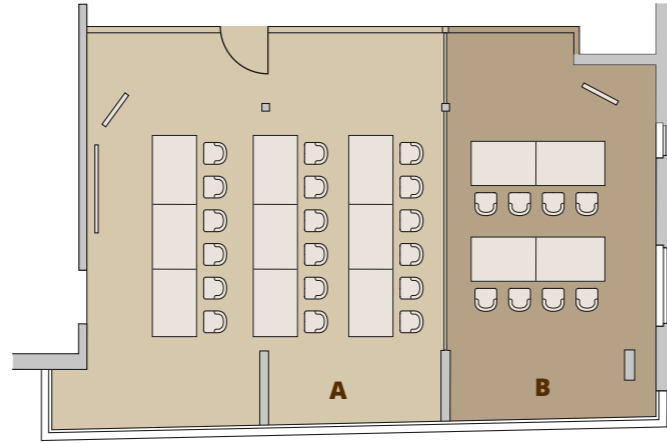

Option 6
Seating capacity A: 18
Seating capacity B: 8

SEATING ARRANGEMENTS

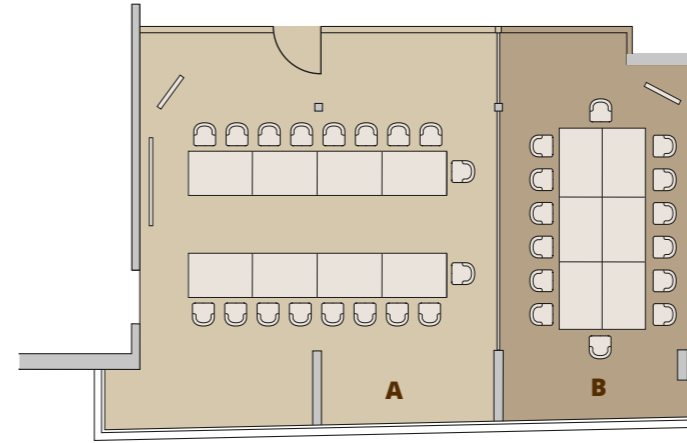

Option 7
Seating capacity A: 18
Seating capacity B: 12

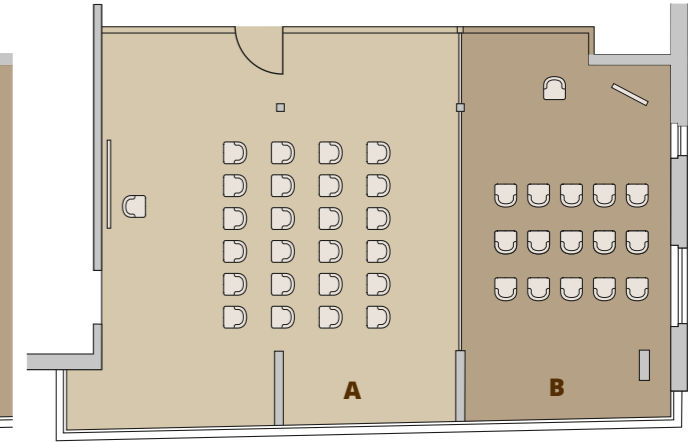

Option 8
Seating capacity A: 24
Seating capacity B: 15



OUTDOOR LOCATION

Mountain lodge Fluhalp

The mountain lodge Fluhalp at 2606 m altitude is located in the ski or hiking area Sunnegga Blauherd Rothorn. The large sun terrace with a spectacular view to the Matterhorn invites you to relax and enjoy. During the winter season (Christmas to Easter), a live band ensures a great vibe. In summer the Fluhalp offers accommodation in rooms or dormitories.

Make it a real hut-romance in the glowing sunrises and sunsets, combined with alpine walks and high-alpine tours

- Technical equipment on request
- Winter garden available for meetings



EVENT ORGANISATION

Program proposals

- Curling tournament with hot wine or Jägertee
- Mountain hut evening at the Restaurant Blatten
- Wine and cheese tasting at a winery in the Rhone Valley or in our restaurant
- Game viewing followed by sledging and cheese fondue
- Visit the Grande Dixence
- Adventure climbing through the Gorner Gorge including Abseiling, Flying Fox, etc. followed by lunch
- Dirt Scooter ride from Sunnegga or Schwarzsee
- Ascent of the Breithorn (easy 4000 metre, about 3 hour hike)
- Visit to the Observatory on the Gornergrat
- Visit of the local cheese dairy followed by a cheese tasting session

We will gladly advise you about other suggestions.





R E S T A U R A N T P I N T E

In our traditional restaurant «Pinte» we serve Valais specialities such as Raclette and cheese fondue, in a really cosy and rustic atmosphere. Our wine list offers a large selection of Valais and foreign wines. On warm summer days you can watch the hustle and bustle of Zermatt from our terrace at the main street.



R E S T A U R A N T A R V E N S T U B E

The restaurant «Arvenstube» offers international cuisine such as Fondue Chinoise and grill specialities. During the high season an opulent salad buffet is available to our guests. Warmly decorated with old wood and quarry stones, the «Arvenstube» is also a perfect setting for celebrations and banquets.

C H Ä M I B A R F I R E P L A C E

Relax after a long day in the fresh air in our cosy bar with fireplace. By the cracking fire, it will be our pleasure to serve you an Apéro, wines by the glass, various cocktails, Amici-Cafe, Ronnefeld tea, Gunzwiler Schnapps (Alpine spirits), Swiss Highland Single Malt Whisky... We offer various snacks such as cured meats or Hobelkäse (cheese speciality).



G A R D E N T E R R A C E

Have a coffee with friends in the afternoon or enjoy a glass of wine on a warm mountain summer's evening. From early June to late September, we serve you on our flower-filled Garden Terrace. It is open for everyone, not only for hotel guests. The Garden Terrace can also be booked for a special occasion.





CONFERENCE ALL-INCLUSIVE FEE

- Use of our conference room, including mineral water
- Standard equipment (beamer, TV / DVD, overhead projector, flipchart, pin board, audio set, etc.)
- 2 coffee breaks with croissants, fruit, biscuits, orange juice

Price per person per day sFr. 29.00



3 course business lunch
from sFr. 35.00 per person

Half board supplement (4 course dinner)
sFr. 44.00 per person





SEMINAR PACKAGE AUTUMN

- 1 night in double room for single occupancy incl. breakfast buffet
- Use of the recreational area with sauna, steam bath, jacuzzi and spa shower
- Free WLAN use throughout the hotel
- Use of our conference room including mineral water
- Standard equipment (beamer, TV / DVD, overhead projector, flipchart, pin board, audio set, etc.)
- 2 coffee breaks with croissants, fruit, biscuits, orange juice
- 3 course business lunch
- 15% reduction on green fees at the Golf Club Matterhorn
- Our mountain lodge Fluhalp is also available for events (please contact us for further information)

Price per person per night sFr. 229.00



SEMINAR PACKAGE WINTER

(January till beginning of February)

- 1 night in double room for single occupancy incl. breakfast buffet
- Use of the recreational area with sauna, steam bath, jacuzzi and spa shower
- Free WLAN use throughout the hotel
- Use of our conference room including mineral water
- Standard equipment (beamer, TV / DVD, overhead projector, flipchart, pin board, audio set, etc.)
- 2 coffee breaks with croissants, fruit, biscuits, orange juice
- 4 course diner

Price per person per night sFr. 263.00





FAMILY TAUGWALDER · Mountaineers · Hoteliers · Hosts

Bahnhofstrasse 25 · Postfach 182 · CH-3920 Zermatt · Switzerland

info@hotelpollux.ch · www.hotelpollux.ch · www.taugwalder.ch